

Installation manual

RACETORX[®]

P E R F O R M A N C E



WWW.RACETORX.CO.UK

RTX479 Brake Junction Valve

This product should be installed by a trained vehicle technician

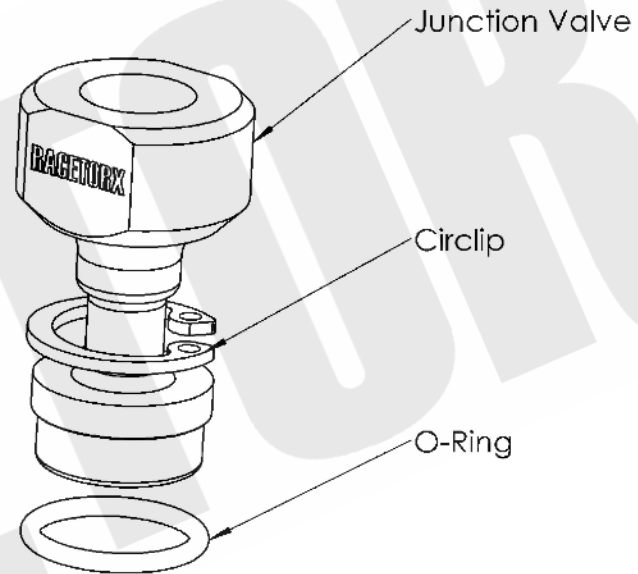



Installation

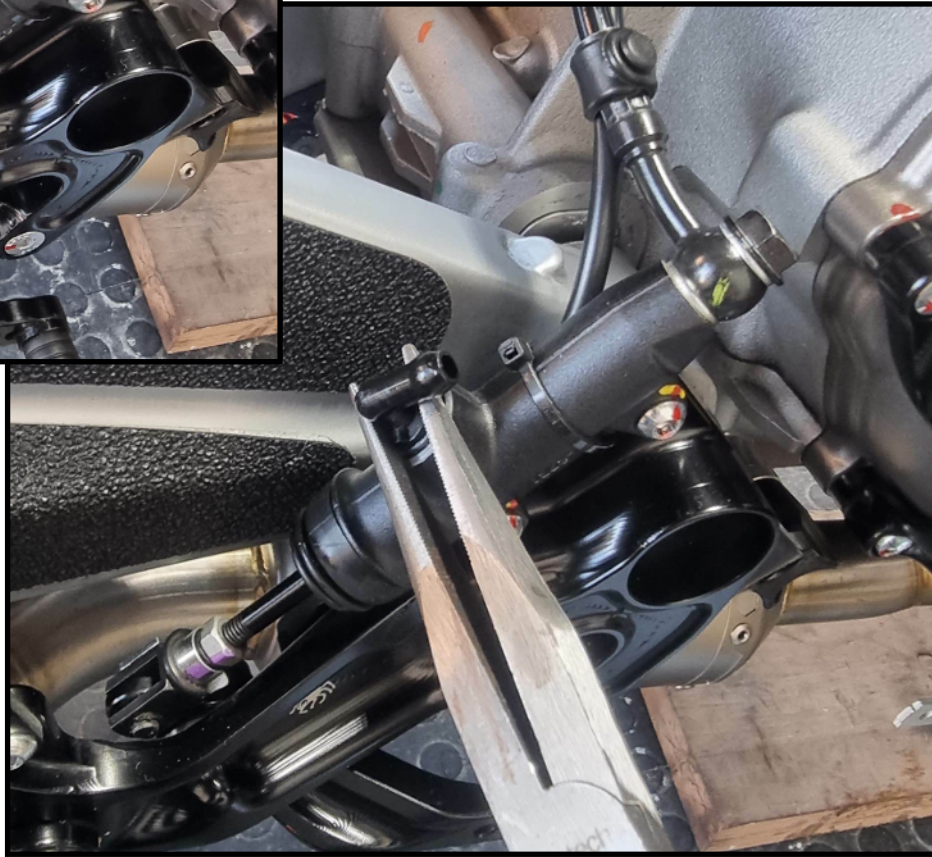
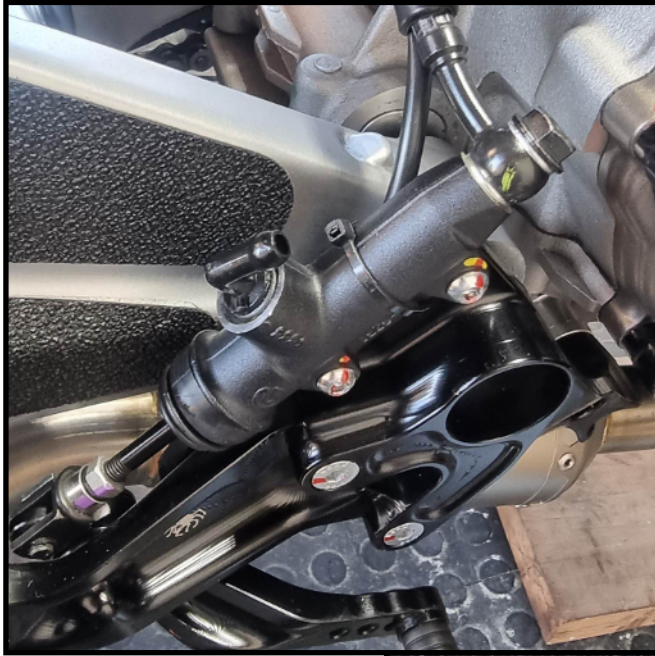

1. With pliers, pry out the plastic reservoir nipple.



2. Remove the rubber doughnut.

Installation

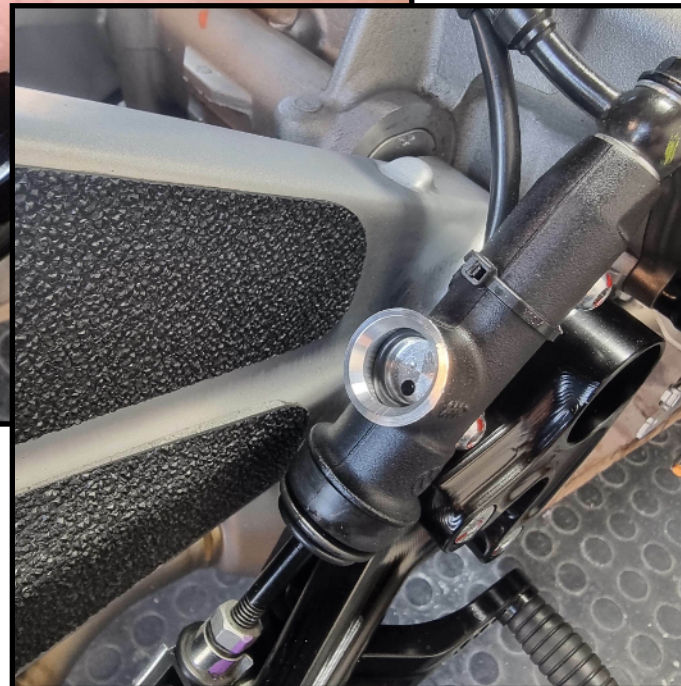

3. Clean the port with tissue/cloth, rub a thin layer of lithium grease or equivalent on the o-ring then place the seal into the port. (The grease acts as a primer to seal as when dry it may weep)

Installation

RACETORX[®]
P E R F O R M A N C E



4. Expand circlip over the junction valve then place into the master cylinder.

5. Once the junction valve is seated in the master cylinder, turn the junction valve and press down to make sure it's seated correctly.

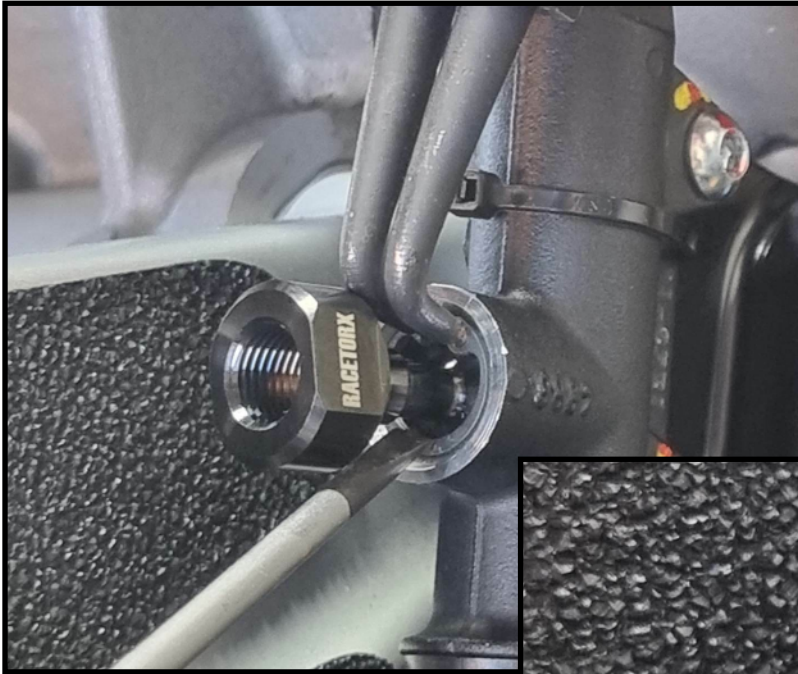

6. Using small circlip pliers install the circlip, it may help to use a small flat head screw driver on the opposite side to install level under the lip. Inspect the fit to ensure that the circlip is seated under the lip properly.





7. Now you can fit the banjo bolt, brake line and copper washers.

8. Reverse bleed the system, due to the air from the rear master cylinder up to your thumb brake or hand brake, doing a conventional bleed is not recommended, instead we recommend you do a reverse bleed, we use the V5 phoenix system back bleed kit which we do offer on our website, or you can use a 200cc syringe which are a low cost item off ebay or amazon.



After installation of the Junction valve:

1. Check any residue of brake fluid is cleaned up and be sure no brake fluid is on the tires.
2. Make sure the circlip is fitted fully under the lip.