

Installation manual

RACETORX[®] [®]
P E R F O R M A N C E

WWW.RACETORX.CO.UK

BMW S1000RR/R/XR

Gear shift support

This product should be installed by a trained vehicle technician

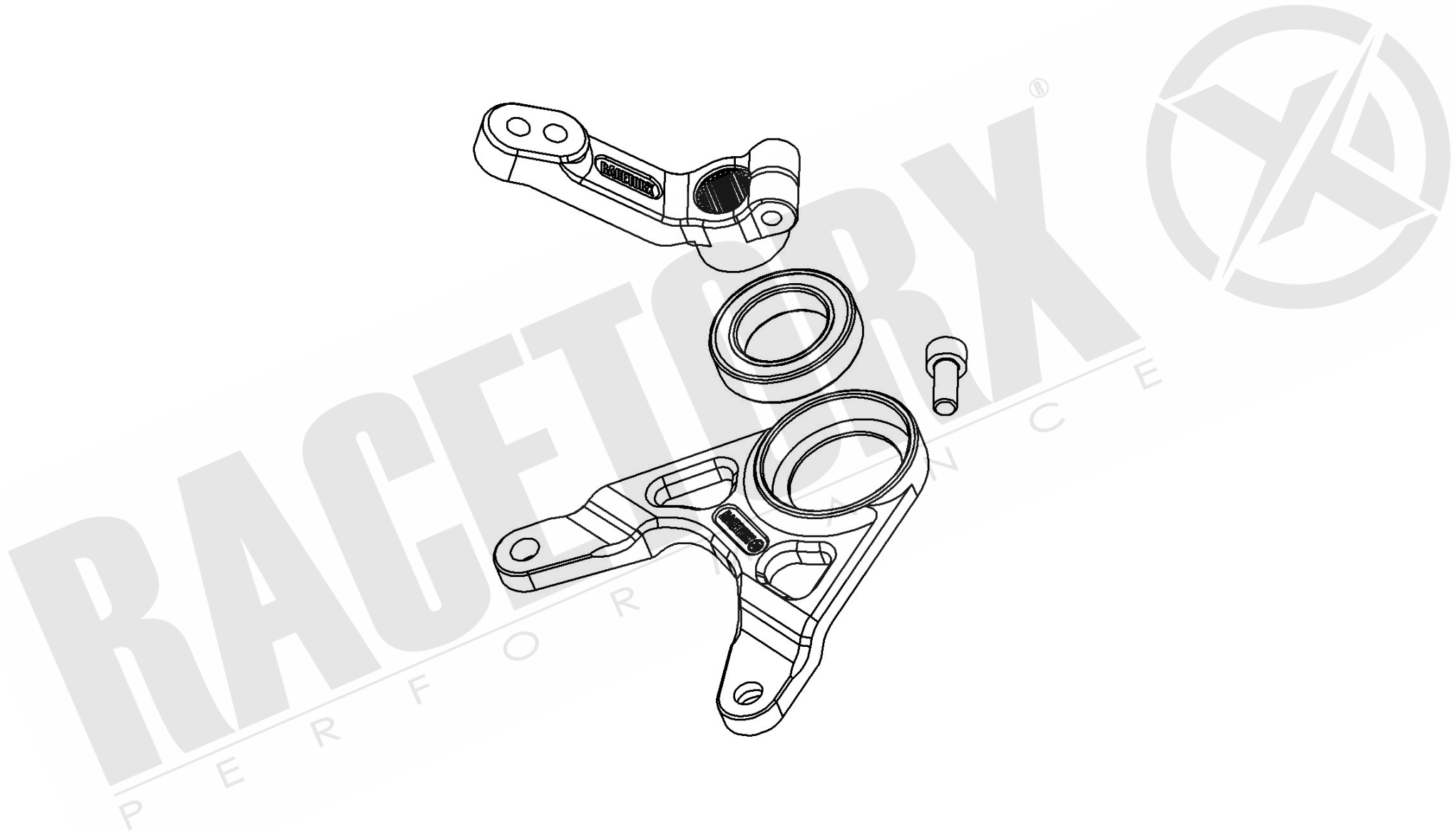
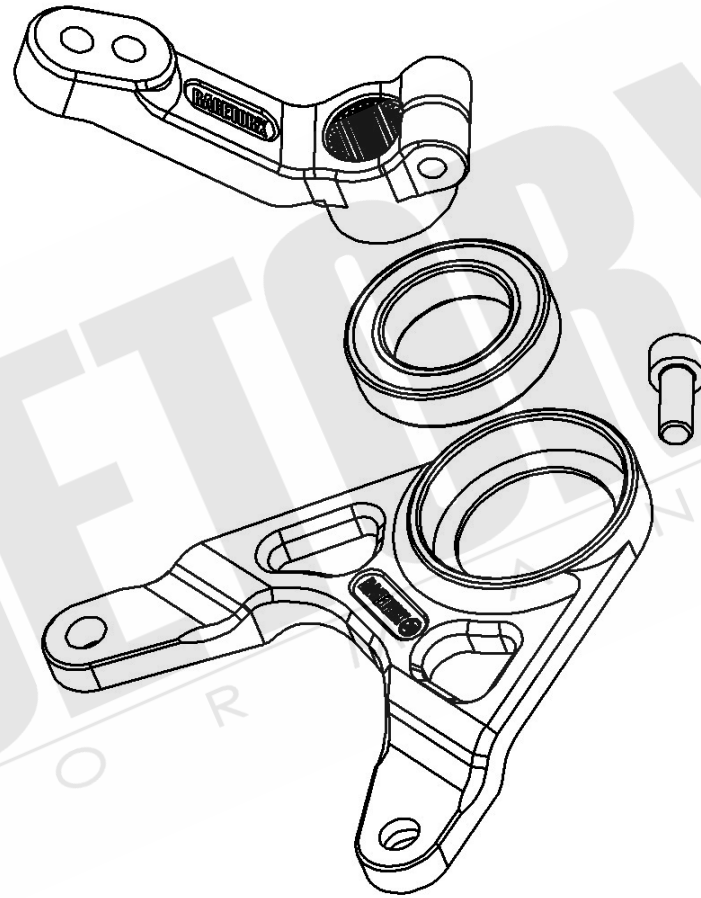



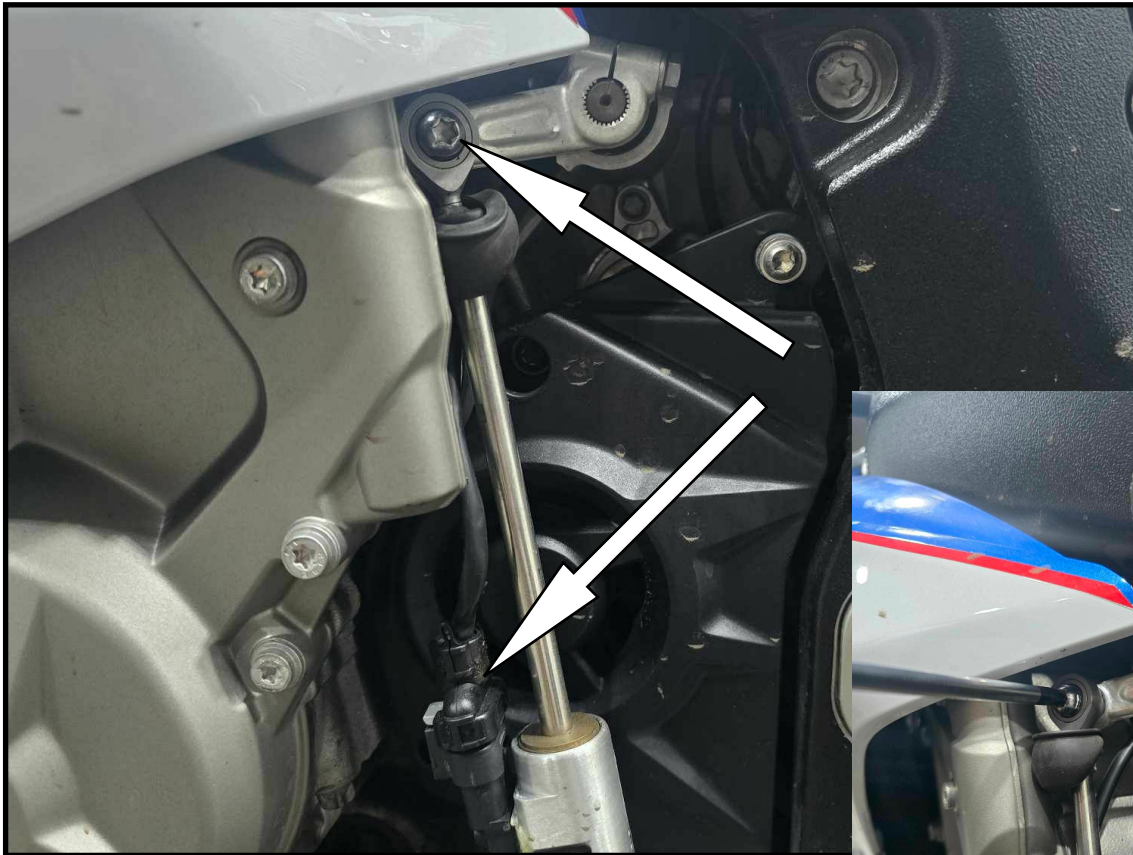

1. Start by removing the bolt and plug on the quick shifter.

2. Move quick shifter away from the sprocket cover.



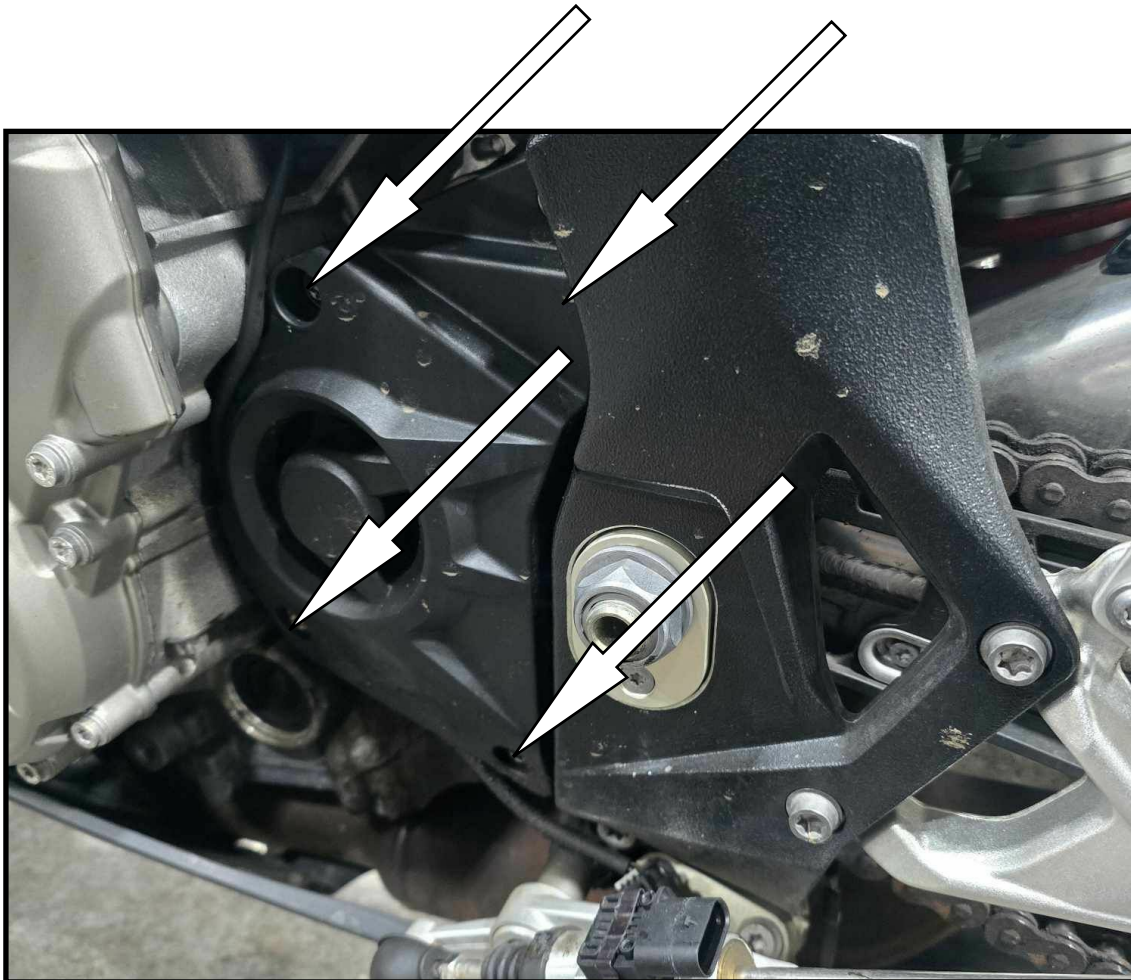

3. Remove bolts holding sprocket cover, removing sprocket cover make sure the 4 spacers in the cover are present and not to lose them as they are not pressed.

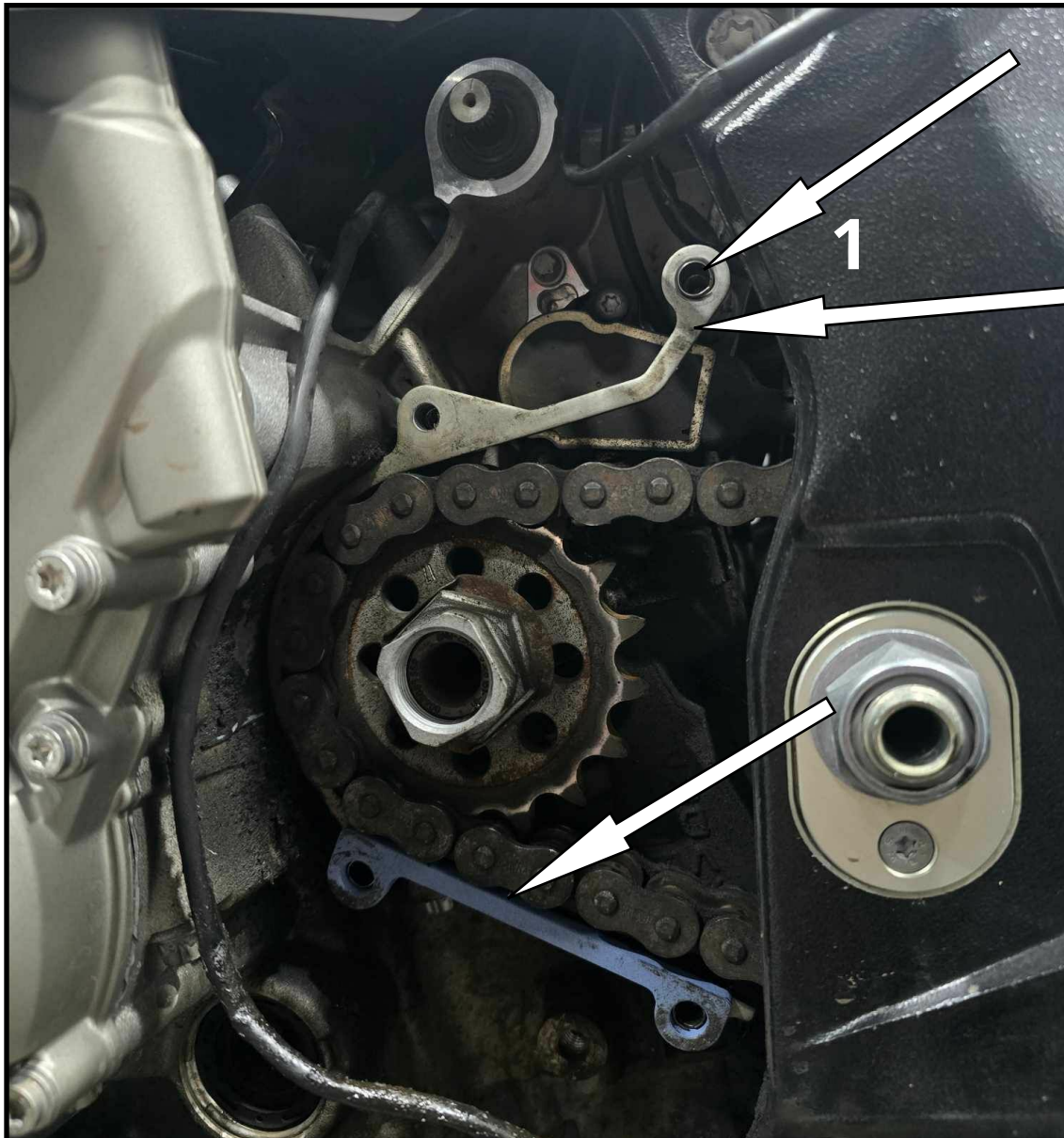

4. Place included plastic spacer over the bottom holes.

Those which do not use a sprocket cover, you do not need to do this step and you have bolts in the kit you can use for mounting the gear shift support.

The chain fin/guard & dowel "1" is a must for this install!

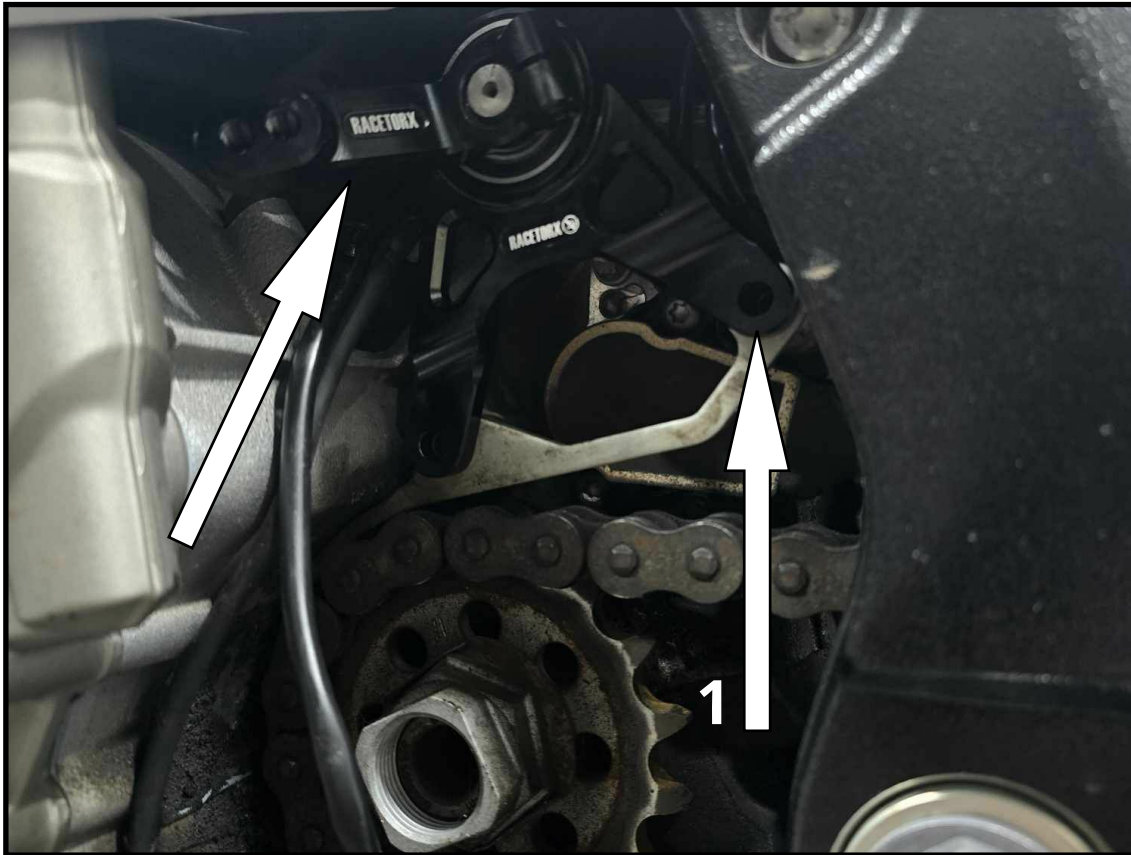

5. Slide the assembly over the gear shaft at the same orientation as the OEM arm.

The OEM gear arm pinch bolt slit follows the dot marker of the gear shaft face. this will indicate the orientation of how to mount the Racetorx gear arm.

6. The bottom right hole "1" must press over the dowel for a flush fit this allows for perfect alignment.



7. A stubby allen key or similar will be required to tighten the allen pinch bolt due to the tight space. 10nm is the correct torque settings for the pinch bolt.

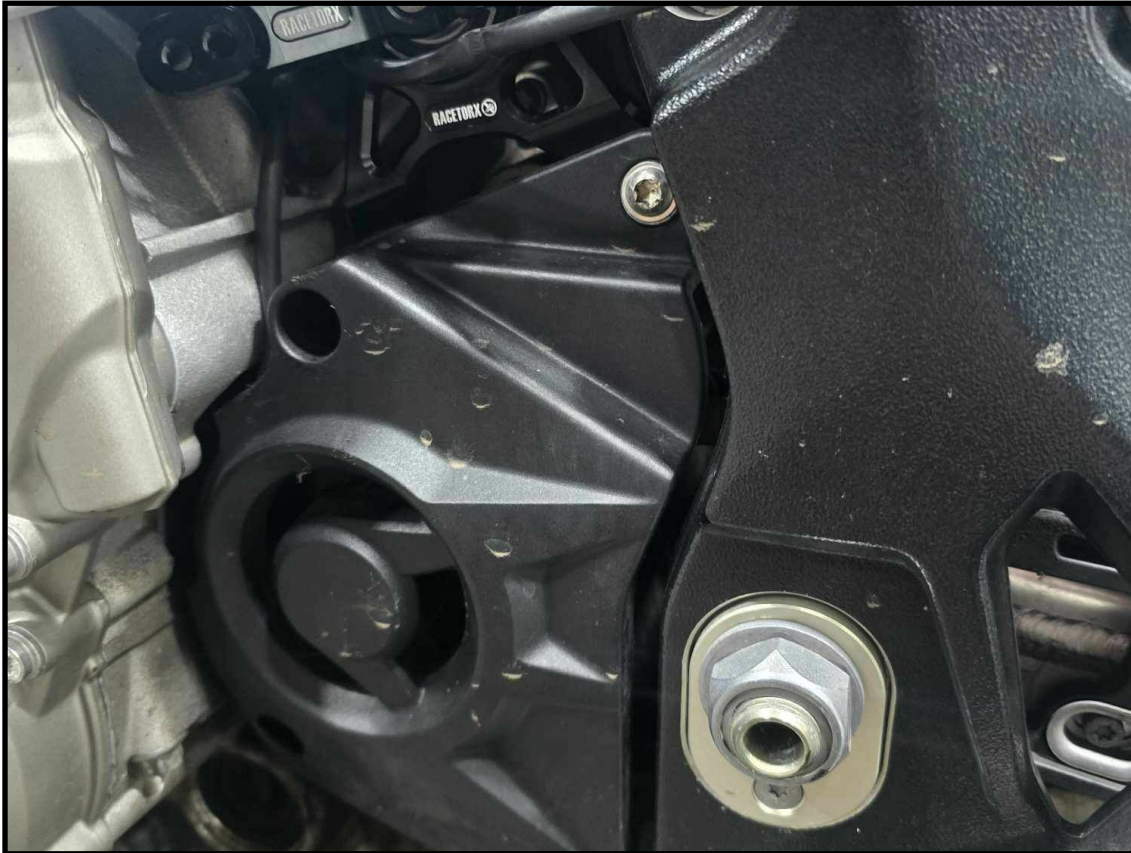

8. Fit sprocket cover over the bottom plastic spacer included and over the gear shift support.

9. Torque top 2 bolts to 10.7NM and 10MN for the bottom 2 bolts.

Ignore the above step if you have not fitted the sprocket cover. The x2 bolts supplied with washers will be required to mount the gear shift support and torque to 10.7NM



10. Fit bolt and torque to 10.7NM and be sure to re-fit quick shifter plug and then place rubber cover back over the bolt.

-You do have an additional bolt location for shorter shifting.

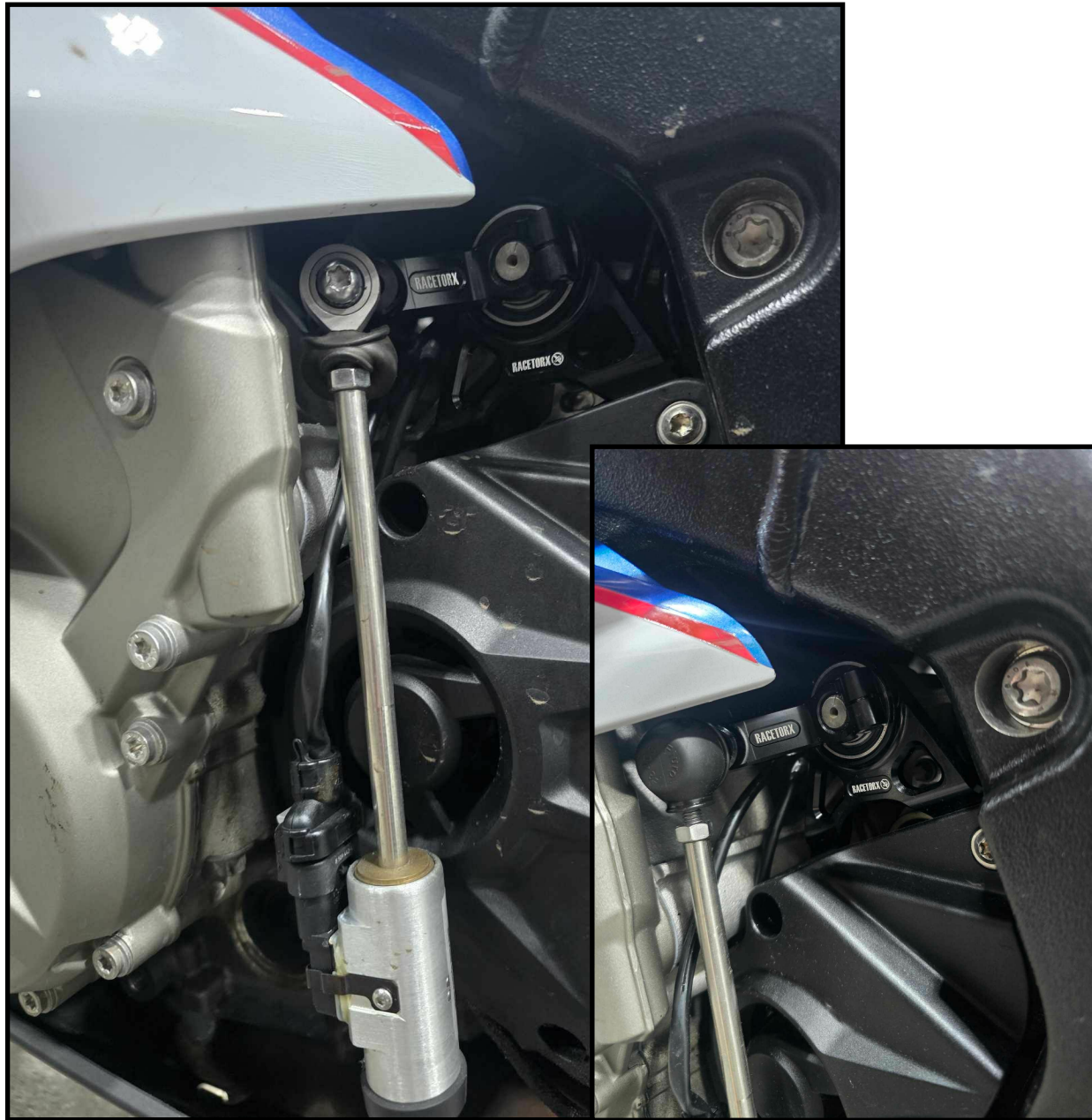



After installation of the gear shift support:

1. Check all bolts have been torqued up correctly.
2. Actuate the gear foot pedal by hand to ensure gear shaft movement is smooth and not binding or sticking.