

Installation manual



WWW.RACETORX.CO.UK

KTM Super Duke 1290 2014-2016 - Gen1/1.0

KTM Super Duke 1290 2017-2019 - Gen2/2.0

KTM Super Duke 1290 GT 2016-2023

Gear shift support

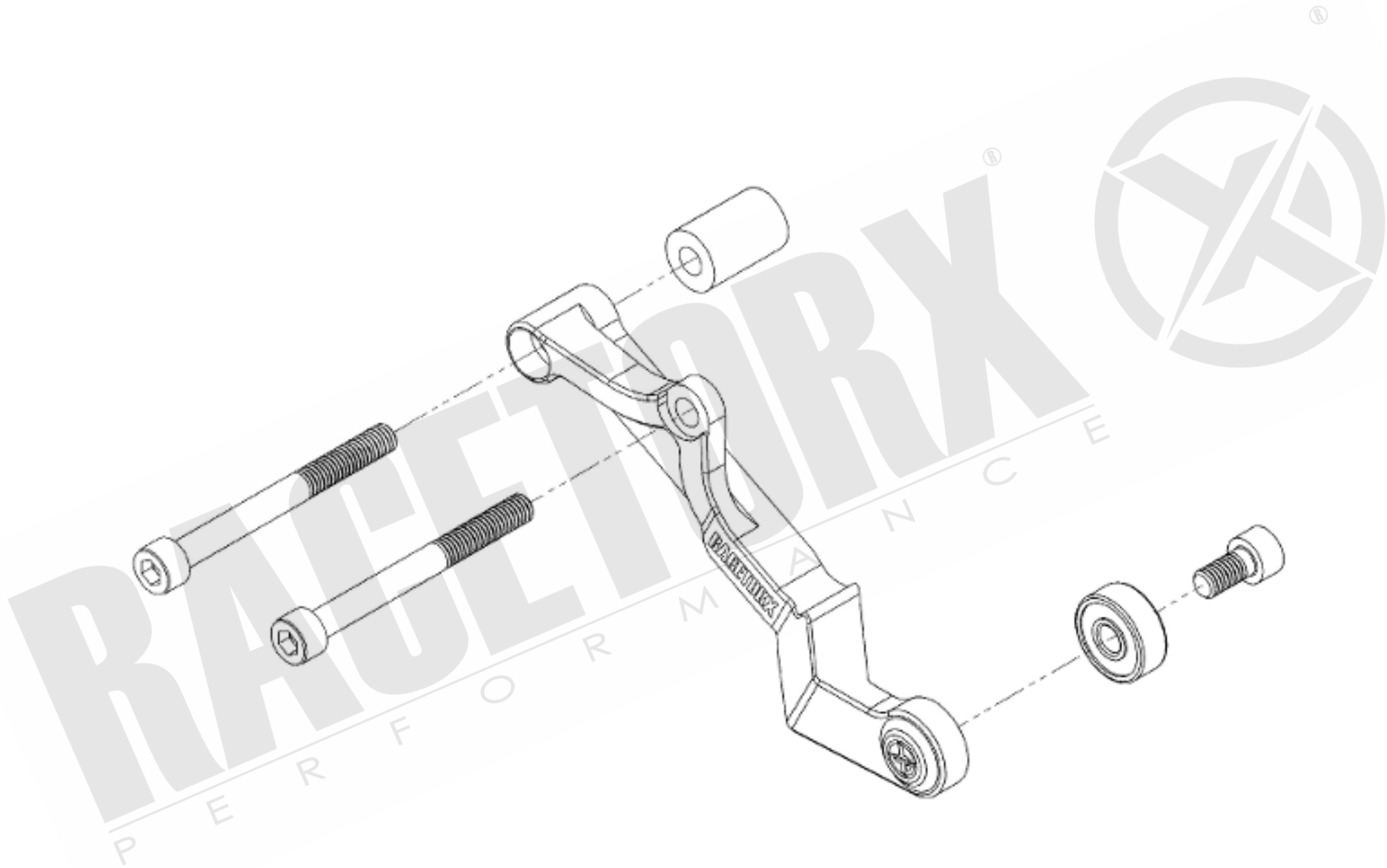



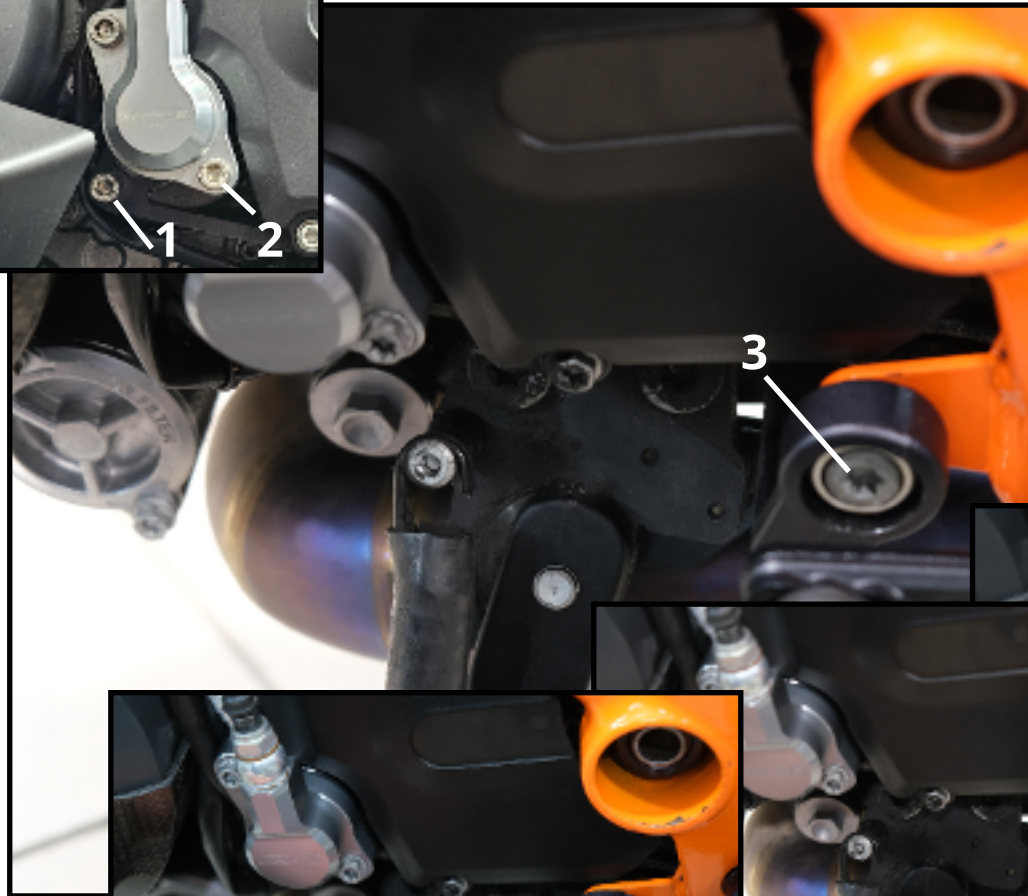

Install by competent individual

1. To begin, remove bolts 1 & 2.
2. Remove torx bolt 3, washer and bearing



3. Press the bearing into the gear arm.



4. When pressing bearing into gear arm, align the back face of the gear shift support to the clutch slave cylinder face.

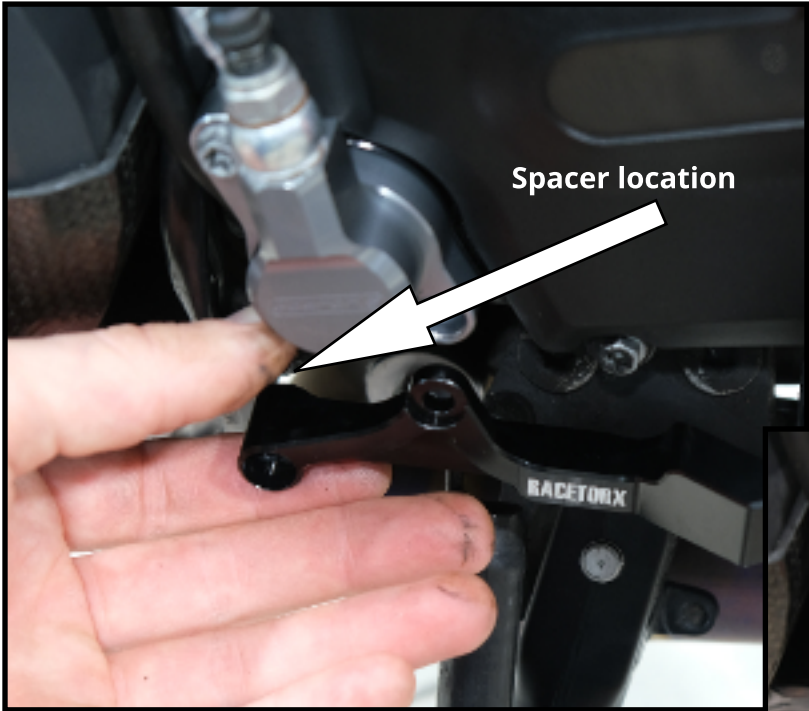

5. Fit spacer behind left mounting hole and place the M6x60 bolts

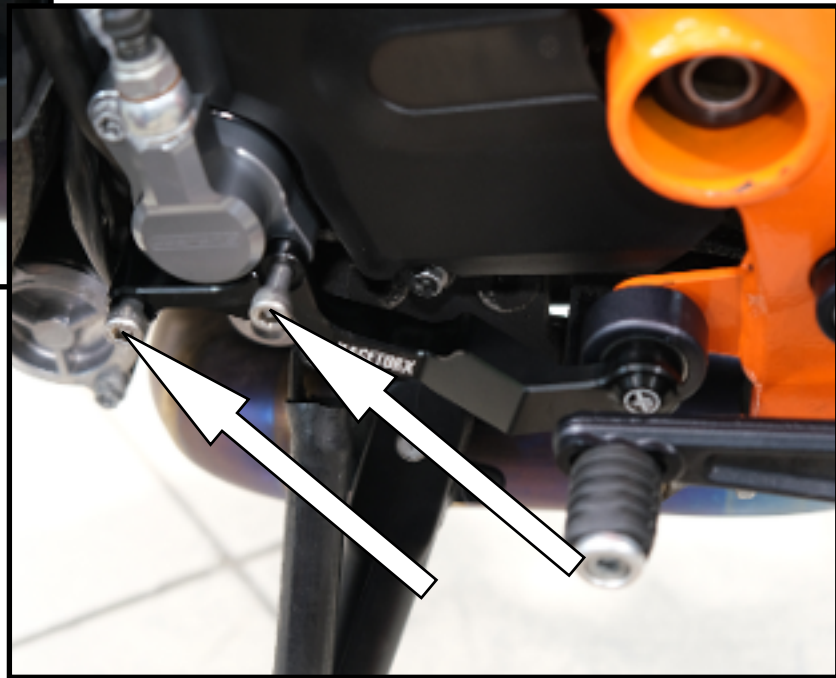

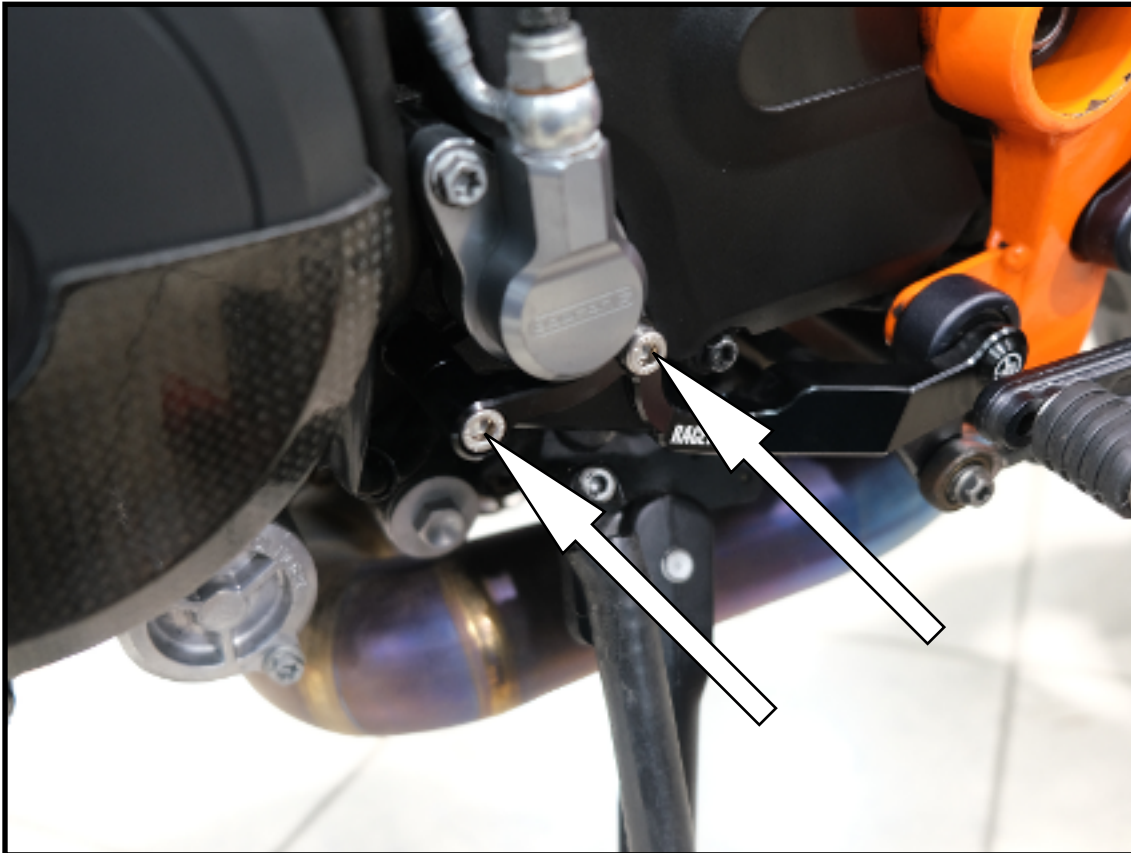

6. Torque the M6x60 bolts to 10.7NM

Suitable for OEM and Oberon clutch slave master cylinders.



After installation of the gear shift support.

1. Check all bolts have been torqued up correctly
2. Actuate the gear foot pedal by hand to ensure gear shaft movement is smooth without any binding or sticking.