

Installation manual



**[WWW.RACETORX.CO.UK](http://WWW.RACETORX.CO.UK)**

**Honda CBR/CB/VTR**

**Gear shift support**

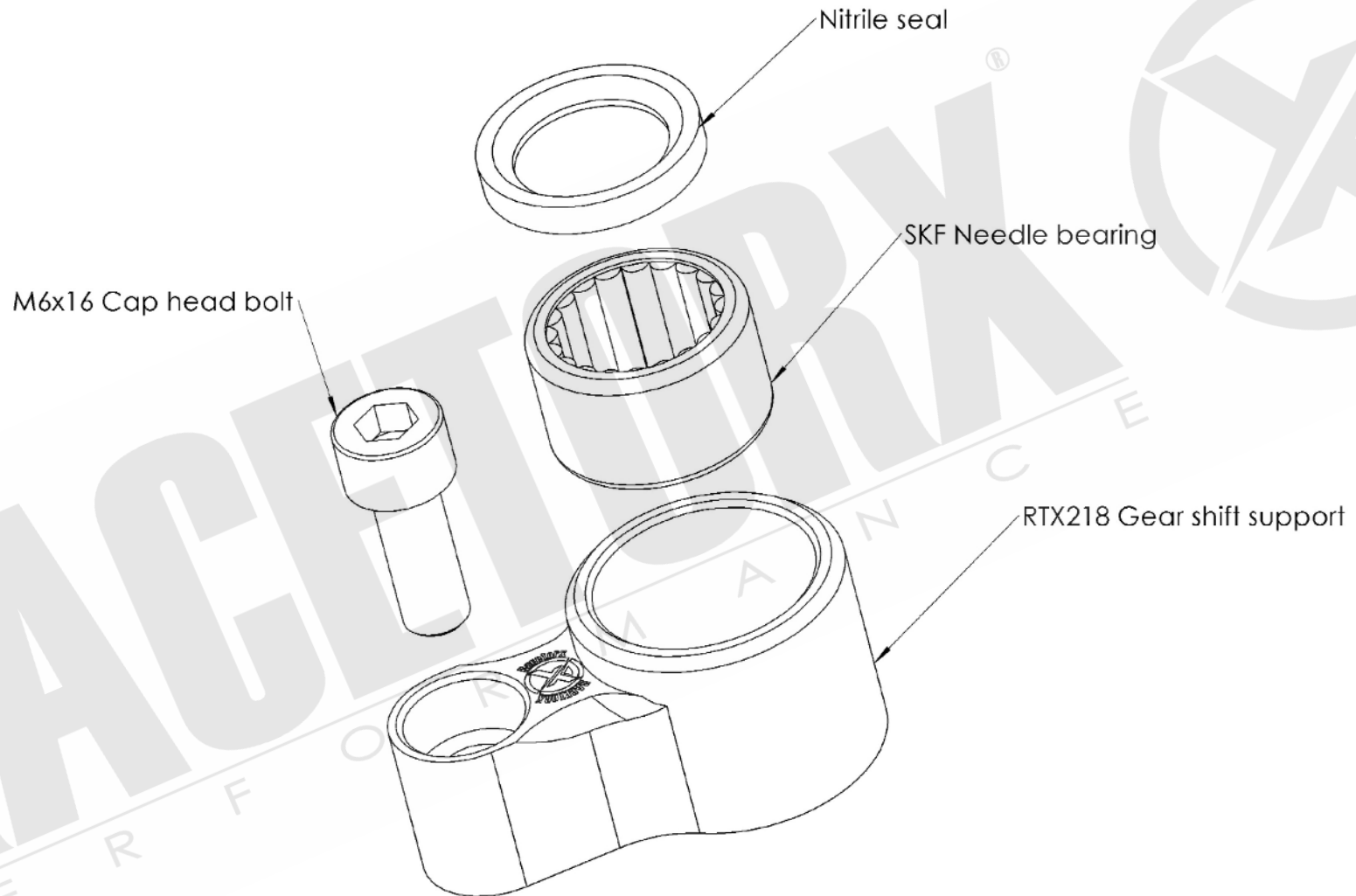



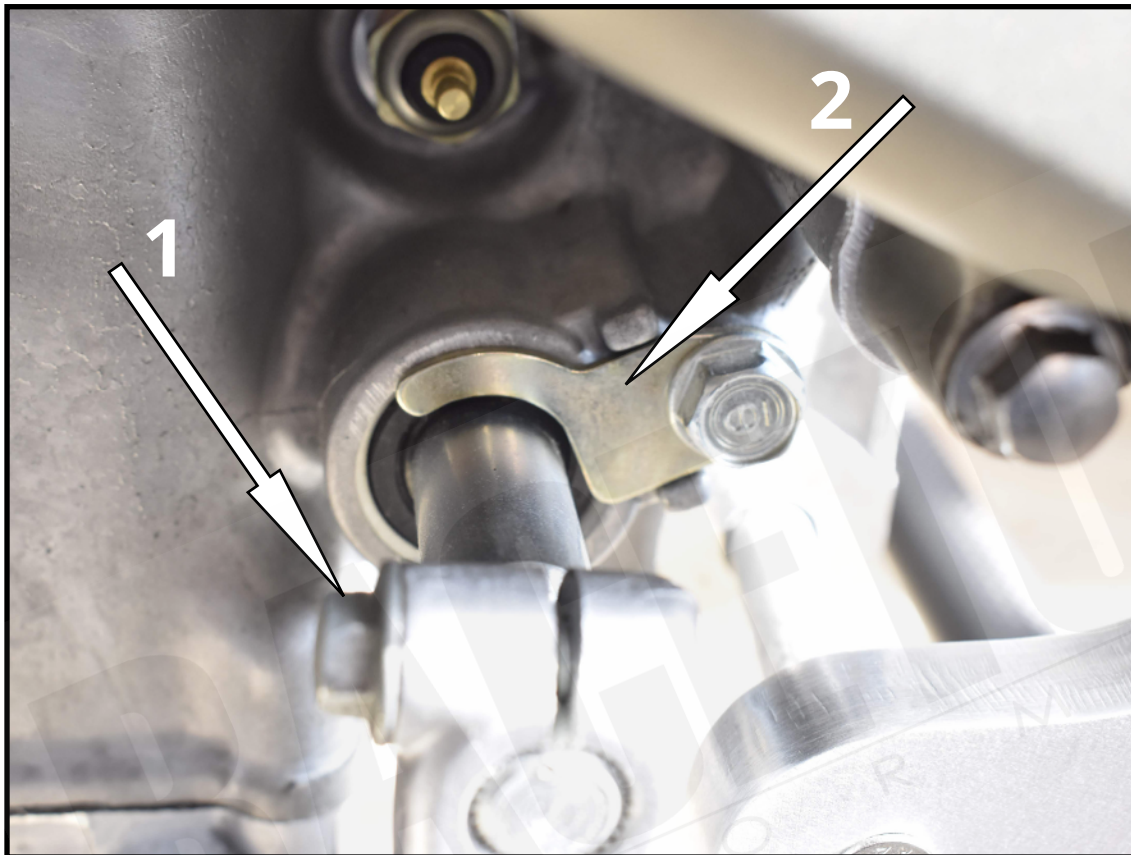

1. Remove bolt and gear arm "1".
2. Remove bolt & "2" c-clip, these you will not require anymore.
3. push grease into the needle bearing so its packed into the gaps of the needles.
4. slide gear shift support over shaft and line up with the threaded hole.
5. torque provided M6 bolt to 10.7nm.
6. refit gear arm and bolt to OEM torque settings.